



FAMILY ESCAPE XT

19.6 FT

Experience the ultimate in compact luxury with the Boutique Family Escape XT, our 19'6" model. Even though it's the smallest in our Family Escape range, this caravan doesn't compromise on capability or comfort. Explore challenging terrain with confidence, knowing its robust chassis and all-terrain capabilities will handle anything you throw at it. Inside, the clever east-west bed layout maximises space and ensures a good night's sleep. Premium materials and cutting-edge technology create a stylish and convenient getaway for unforgettable adventures – proving that good things come in small packages.

**FAMILY VAN CENTRE
DOOR ENTRY**

**CENTRE DOOR ENTRY - FAMILY
VAN**

**FULL OFF ROAD
EAST, WEST BED**

CHASSIS

- EXTENDED A FRAME
- 6 INCH CHASSIS
- TANDEM AXLE
- JOCKEY WHEEL
- FULL OFF ROAD CRUISEMASTER XT SUSPENSION
- SUPERGAL OFF-ROAD CHASSIS
- MUD/ALL- TERRAIN TYRES ON
- 16' CUSTOM WHEELS (SPARE WHEEL INCLUDED)
- CRUISEMASTER DO35 V3 COUPLING
- WITH INTEGRATED HANDBRAKE
- DROP-DOWN STABILISER JACKS
- GALVANISED 3-ARM BUMPER BAR
- WITH SPARE WHEEL
- STEEL ENTRY STEP
- BREAKAWAY SAFETY SYSTEM
- ELECTRIC BRAKES TO ALL WHEELS

EXTERIOR

- MARINE-GRADE SMOOTH FINISH
- COMPOSITE PANELS
- BOUTIQUE SIGNATURE ONE PIECE FIBERGLASS ROOF
- EASY TO USE PREMIUM AWNING
- HEAVY DUTY MUDFLAPS
- HIGH CHECKER PLATE BODY ARMOR & WHEEL SPATS
- GRAB HANDLES
- CRIMSAFE TRIPLE-LOCK ENTRY DOOR WITH ALUMINIUM SECURITY MESH & BLIND
- TINTED SLEEK FLAT-PANE DOUBLE GLAZED WINDOWS
- BOUTIQUE VINYL DECAL KIT
- EXTERNAL ENTERTAINMENT PACK
- TV POINT & EXTERNAL SPEAKERS
- BUBBLE LIGHT GRAB HANDLE
- PICNIC TABLE WITH LED LIGHTING
- PULL-OUT STEP
- EXTRA LARGE TOOLBOX WITH DOUBLE SIDED SLIDE-OUT STORAGE
- SAFETY DAVE REVERSE CAMERA WITH MONITOR

INTERNAL

- UNIQUELY DESIGNED ERGONOMIC FLOORPLAN. ALTERNATIVE LAYOUTS AVAILABLE
- BOUTIQUE SIGNATURE ONE PIECE HONEYCOMB CORE WATERPROOF FLOOR
- UPGRADED CONTEMPORARY MATTE BLACK SINKS, TAPS, SHOWER & HARDWARE PACK
- FILTERED WATER
- GAS STRUT OVERHEAD CUPBOARDS & SOFT CLOSE DRAWERS
- PREMIUM RANGE LAMINATE
- BENCH TOPS
- EUROPEAN-MADE VINYL FLOORING (HUGE RANGE OF COLOURS/STYLES AVAILABLE)
- MIDGEE PROOF MESH & BLOCK OUT BLINDS
- MODERN & CONTEMPORARY FURNITURE WITH BOUTIQUE CARAVANS PREMIUM CABINETRY
- RESIDENTIAL GRADE PIANO HINGE ASSEMBLY
- PREMIUM LOUNGE SEATING
- CEILING MOUNT SPEAKERS
- BEDROOM PIGEONHOLES WITH ONE-X USB POWERPOINTS
- BEDROOM & BUNK FANS
- DOUBLE GLAZED WINDOWS
- REVERSE CYCLE FANS IN SHOWER/ENSUITE
- 2X SKYLIGHTS
- QUEEN SIZE PILLOW TOP INNERSPRING MATTRESS
- SOFT PANEL TRIPLE BUNK BEDS
- SAFETY PACK: SMOKE ALARMS &
- FIRE EXTINGUISHER

APPLIANCES

- TOP OF THE RANGE BUSHMAN 194L COMPRESSOR FRIDGE
- SWIFT FULL OVEN/GRILLER/ COOKTOP
- SLIMLINE RANGEHOOD
- 25LTR MICROWAVE
- REVERSE CYCLE HEATING & COOLING
- 3.5KG FRONTLOAD WASHING MACHINE
- PREMIUM SOUND PACKAGE
- BLUETOOTH/USB/CD/RADIO WITH INTERNAL & EXTERNAL SPEAKERS

ELECTRICAL

- COMPLETE LED LIGHTS
- DOWNLIGHTS
- READING LIGHTS
- TUNNEL BOOT LIGHTS
- STRIP LIGHTING
- ANTI-INSECT ANNEX LIGHTS
- FRONT & REAR WORK LIGHTS WITH EXTERNAL SWITCH
- 12 PIN PLUG WITH ANDERSON PLUG
- ONE-X USS POWERPOINT THROUGHOUT DOUBLE POLE POWERPOINTS
- EXTERNAL POWER POINT
- ARIZON - VICTRON ENERGY (MICRO BOARD)
- BM PRO TREK3 DISPLAY
- 2X 200W SOLAR PANELS
- 2X 120AH AGM BATTERIES
- WINEGARD ANTENNA

PLUMBING

- SWIFT GAS AND ELECTRIC HOW WATER SYSTEM
- THETFORD CERAMIC TOILET
- ONE PIECE FIBERGLASS SHOWER
- 2X 95LTR FRESH WATER TANKS
- LX 95LTR GREY WATER TANK
- DUAL GAS BOTTLES
- WATER TAP ON A-FRAME

WEIGHT AND DIMENSIONS

TARE: 2650 KG
BALL WEIGHT: 180KG
ATM: 3500KG

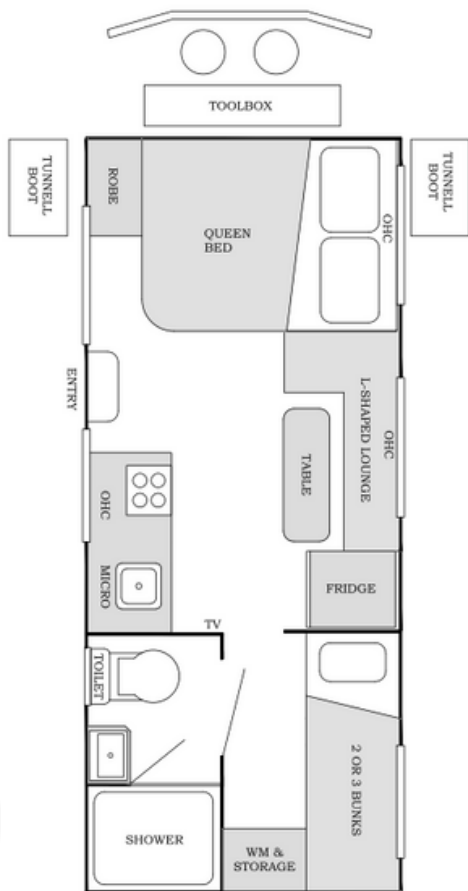

**FAMILY VAN CENTRE
DOOR ENTRY**

**CENTRE DOOR ENTRY - FAMILY
VAN**

**FULL OFF ROAD
EAST, WEST BED**